

## **Bearing Accessories**

**UBC produces and supplies many different accessories for rolling bearings, including bearing housing, adapter sleeve, withdrawal sleeve, lock nuts and locking clips or washers. Please contact UBC for further technical data or information needed.**

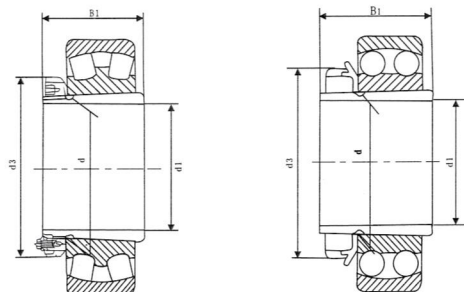

H2 series

Designation			dimensions				assorted bearings	Weight kg
adapter sleeve	Lock nut	locking washer	d	d <sub>1</sub>	B <sub>1</sub>	d <sub>3</sub>	ball bearing	
H204	KM04	MB04	20	17	24	32	1204K	0.04
H205	KM05	MB05	25	20	26	38	1205K	0.07
H206	KM06	MB06	30	25	27	45	1206K	0.10
H207	KM07	MB07	35	30	29	52	1207K	0.13
H208	KM08	MB08	40	35	31	58	1208K	0.17
H209	Km09	Mb09	45	40	32	65	1209K	0.23
H210	KM10	MB10	50	45	35	70	1210K	0.27
H211	KM11	MB11	55	50	37	75	1211K	0.31
H212	KM12	MB12	60	55	38	80	1212K	0.35
H213	KM13	MB13	65	60	40	85	1213K	0.40
H214	KM14	MB14	70	60	41	92	1214K	0.55
H215	KM15	MB15	75	65	43	98	1215K	0.71
H216	KM16	MB16	80	70	46	105	1216K	0.88
H217	KM17	MB17	85	75	50	110	1217K	1.02
H218	KM18	MB18	90	80	52	120	1218K	1.19
H219	KM19	MB19	95	85	55	125	1219K	1.37
H220	KM20	MB20	100	90	58	130	1220K	1.49
H222	KM22	MB22	110	100	63	145	1222K	1.93

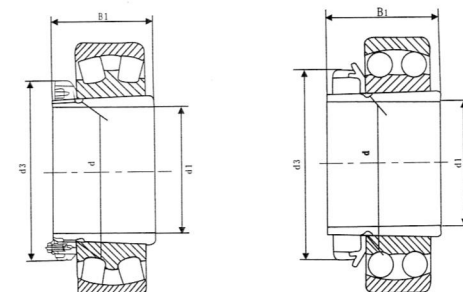

H3 series

Designation			dimensions				assorted bearings			Weight kg	
adapter sleeve	Lock nut	locking washer	d	d <sub>1</sub>	B <sub>1</sub>	d <sub>3</sub>	ball bearing	Roller bearing			
H304	KM04	MB04	20	17	28	32	1304K	2204K	21304CK	0.05	
H305	KM05	MB05	25	20	29	38	1305K	2205K	21305CK	0.08	
H306	KM06	MB06	30	25	31	45	1306K	2206K	21306CK	0.11	
H307	KM07	MB07	35	30	35	52	1307K	2207K	21307CK	0.14	
H308	KM08	MB08	40	35	36	58	1308K	2208K	21308CK	22208CK	0.19
H309	KM09	MB09	45	40	39	65	1309K	2209K	21309CK	22209CK	0.25
H310	KM10	MB10	50	45	42	70	1310K	2210K	21310CK	22210CK	0.30
H311	KM11	MB11	55	50	45	75	1311K	2211K	21311CK	22211CK	0.35
H312	KM12	MB12	60	55	47	80	1312K	2212K	21312CK	22212CK	0.39
H313	KM13	MB13	65	60	50	85	1313K	2213K	21313CK	22213CK	3.46
H314	KM14	MB14	70	60	52	92	1314K	2214K	21314CK	22214CK	0.72
H315	KM15	MB15	75	65	55	98	1315K	2215K	21315CK	22215CK	0.83
H316	KM16	MB16	80	70	59	105	1316K	2216K	21316CK	22216CK	1.03
H317	KM17	MB17	85	75	63	110	1317K	2217K	21317CK	22217CK	1.18
H318	KM18	MB18	90	80	65	120	1318K	2218K	21318CK	22218CK	1.37
H319	KM19	MB19	95	85	68	125	1319K	2219K	21319CK	22219CK	1.56
H320	KM20	MB20	100	90	71	130	1320K	2220K	21320CK	22220CK	1.69
H322	KM22	MB22	110	100	77	145	1322K	2222K	21322CK	22222CK	2.18

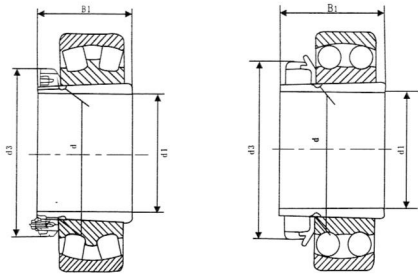

H30 series

Designation			dimensions				assorted bearings	Weight kg
adapter sleeve	Lock nut	locking washer	d	d <sub>1</sub>	B <sub>1</sub>	d <sub>3</sub>	Roller bearing	
H3024	KML 24	MSL 24	120	110	72	145	23024CK	1.93
H3026	KML 26	MSL 24	130	115	80	155	23026CK	2.85
H3028	KML 28	MSL 28	140	125	82	165	23028CK	3.16
H3030	KML 30	MSL 30	150	135	87	180	23030CK	3.89
H3032	KML 32	MSL 32	160	140	93	190	23032CK	5.21
H3034	KML 34	MSL 34	170	150	101	200	23034CK	5.99
H3036	KML 36	MSL 36	180	160	109	210	23036CK	6.83
H3038	KML 38	MSL 38	190	170	112	220	23038CK	7.45
H3040	KML 40	MSL 40	200	180	120	240	23040CK	9.19
H3044	HML 44	MSL 44	220	200	126	260	23044CK	10.30
H3048	HML 48	MSL 48	240	220	133	290	23048CK	13.20
H3052	HML 52	MSL 48	260	240	145	310	23052CK	15.30
H3056	HML 56	MSL 56	280	260	152	330	23056CK	17.70
H3060	HML 60	MSL 60	300	280	168	360	23060CK	22.80
H3064	HML 64	MSL 64	320	300	171	380	23064CK	24.60
H3068	HML 68	MSL 64	340	320	187	400	23068CK	28.70
H3072	HML 72	MSL 72	360	340	188	420	23072CK	30.50
H3076	HML 76	MSL 76	380	360	193	450	23076CK	35.80
H3080	HML 80	MSL 76	400	380	210	470	23080CK	41.50
H3084	HML 84	MSL 84	420	400	212	490	23084CK	43.60
H3088	HML 88	MSL 88	440	410	228	520	23088CK	65.50
H3092	HML 92	MSL 88	460	430	234	540	23092CK	69.40
H3096	HML 96	MSL 96	480	450	237	560	23096CK	73.50
H30/500	HML /500	MSL 96	500	470	247	580	23/500CK	82.00

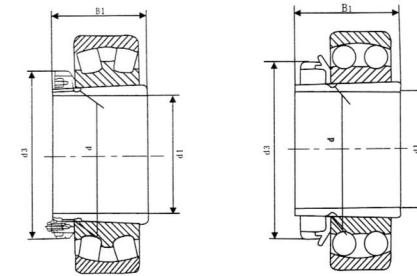

H31 series

Designation			dimensions				assorted bearings		Weight kg
adapter sleeve	Lock nut	locking washer	d	d <sub>1</sub>	B <sub>1</sub>	d <sub>3</sub>	ball bearing		
H3120	KM 20	MB 20	100	90	76	130	23120CK	1.70	
H3122	KM 22	MB 22	110	100	81	145	23122CK	2.25	
H3124	KM 24	MB 24	120	110	88	155	23124CK	2.64	
H3126	KM 26	MB 26	130	115	92	165	23126CK	3.66	
H3128	KM 28	MB 28	140	125	97	180	23128CK	4.34	
H3130	KM 30	MB 30	150	135	111	195	23130CK	5.52	
H3132	KM 32	MB 32	160	140	119	210	23132CK	7.67	
H3134	KM 34	MB 34	170	150	122	220	23134CK	8.38	
H3136	KM 36	MB 36	180	160	131	230	23136CK	9.50	
H3138	KM 38	MB 38	190	170	141	240	23138CK	10.80	
H3140	KM 40	MB 40	200	180	150	250	23140CK	12.10	
H3144	HM 44	MS 44	220	200	161	280	23144CK	14.70	
H3148	HM 48	MS 44	240	220	172	300	23148CK	17.30	
H3152	HM 52	MS 52	260	240	190	330	23152CK	22.00	
H3156	HM 56	MS 52	280	260	195	350	23156CK	24.50	
H3160	HM 60	MS 60	300	280	208	380	23160CK	30.20	
H3164	HM 64	MS 64	320	300	226	400	23164CK	34.90	
H3168	HM 68	MS 68	340	320	254	440	23168CK	49.50	
H3172	HM 72	MS 68	360	340	259	460	23172CK	54.50	
H3176	HM 76	MS 76	380	360	264	490	23176CK	61.60	
H3180	HM 80	MS 80	400	380	272	520	23180CK	70.80	
H3184	HM 84	MS 80	420	400	304	540	23184CK	84.50	
H3192	HM 92	MS 88	460	430	326	580	23192CK	116.00	
H3196	HM 96	MS 96	480	450	335	620	23196CK	133.00	
H31/500	HM /500	MS /500	500	470	356	630	231/500CK	146.00	

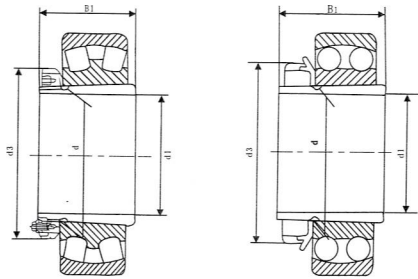

H23 series

Designation			dimensions				assorted bearings		Weight kg
adapter sleeve	Lock nut	locking washer	d	d <sub>1</sub>	B <sub>1</sub>	d <sub>3</sub>	ball bearing	Roller bearing	
H2306	KM06	MB06	30	23	38	45	2306K		0.13
H2307	KM07	MB07	35	30	43	52	2307K		0.17
H2308	KM08	MB08	40	35	46	58	2308K	22308CK	0.22
H2309	KM09	MB09	45	40	50	65	2309K	22309CK	1.28
H2310	KM10	MB10	50	45	55	70	2310K	22310CK	0.36
H2311	KM11	MB11	55	50	59	75	2311K	33211CK	0.42
H2312	KM12	MB12	60	55	62	80	2312K	22312CK	0.48
H2313	KM13	MB13	65	60	65	85	2313K	22313CK	0.56
H2314	KM14	MB14	70	60	68	92	2314K	22314CK	0.90
H2315	KM15	MB15	75	65	73	98	2315K	22315CK	1.05
H2316	KM16	MB16	80	70	78	105	2316K	22316CK	1.28
H2317	KM17	MB17	85	75	82	110	2317K	22317CK	1.45
H2318	KM18	MB18	90	80	86	120	2318K	22318CK	1.69
H2319	KM19	MB19	95	85	90	125	2319K	22319CK	1.92
H2320	KM20	MB20	100	90	97	130	2320K	22320CK	2.16
H2322	KM22	MB22	110	100	105	145	2322K	22322CK	2.74
H2324	KM24	MB24	120	110	112	155	2324K	22324CK	3.19
H2326	KM26	MB26	130	115	121	165	2326K	22326CK	4.60
H2328	KM28	MB28	140	125	131	180	2328K	22328CK	5.55
H2330	KM30	MB30	150	135	139	195	2330K	22330CK	6.63
H2332	KM32	MB32	160	140	147	210	2332K	22332CK	9.14
H2334	KM34	MB34	170	150	154	220	2334K	22334CK	10.20
H2336	KM36	MB36	180	160	164	230	2336K	22336CK	11.30
H2338	KM38	MB38	190	170	169	240	2338K	22338CK	12.60
H2340	KM40	MB40	200	180	176	250	2340K	22340CK	13.90
H2344	HM44	MS44	220	200	186	280	2344K	22344CK	16.70
H2348	HM48	MS44	240	220	199	300	2348K	22348CK	19.70
H2352	HM52	MS52	260	240	211	330	2352K	22352CK	24.20
H2356	HM56	MS52	280	260	224	350	2356K	22356CK	27.80

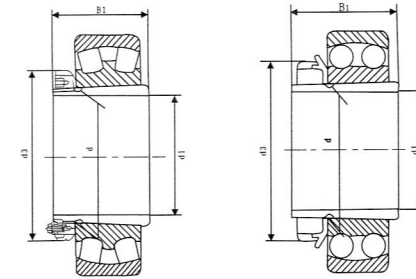

H32 series

Designation			dimensions				assorted bearings	Weight kg
adapter sleeve	Lock nut	locking washer	d	d <sub>1</sub>	B <sub>1</sub>	d <sub>3</sub>	Roller bearing	
H3260	HM 60	MS 60	300	280	240	380	23260CK	34.00
H3264	HM 64	MS 64	320	300	258	400	23264CK	39.40
H3268	HM 68	MS 68	340	320	288	440	23268CK	54.00
H3272	HM 72	MS 68	360	340	299	460	23272CK	60.20
H3276	HM 76	MS 76	380	360	310	490	23276CK	69.60
H3280	HM 80	MS 80	400	380	328	520	23280CK	81.00
H3284	HM 84	MS 80	420	400	352	540	23284CK	94.00
H3288	HM 88	MS 88	440	410	361	560	23288CK	118.00
H3292	HM 92	MS 88	460	430	382	580	23292CK	132.00
H3296	HM 96	MS 96	480	450	397	620	23294CK	150.00
H32/500	HM /500	MS /500	500	470	428	630	232/500CK	166.00